

Qty. Description

1 CM 5-5 A-R-G-E-AVBE C-A-A-N



Note! Product picture may differ from actual product

Product No.: [96935461](#)

Compact, reliable, horizontal, multistage, end-suction centrifugal pump with axial suction port and radial discharge port. Pump materials in contact with the liquid are in high-grade stainless steel. The mechanical shaft seal is a special designed, unbalanced O-ring seal. Pipework connection is via internal Whitworth pipe threads, Rp (ISO 7/1).

The pump is fitted with a 1-phase, foot-mounted, fan-cooled asynchronous motor.

Controls:

Frequency converter: NONE

Liquid:

Pumped liquid: Water
Liquid temperature range: -20 .. 90 °C
Selected liquid temperature: 20 °C
Density: 998.2 kg/m³

Technical:

Pump speed on which pump data are based: 2900 rpm
Actual calculated flow: 4.835 m³/h
Rated flow: 4.7 m³/h
Resulting head of the pump: 34.8 m
Rated head: 38.62 m
Code for shaft seal: AVBE
Approvals: CE,EAC,UKCA
Approvals for drinking water: ACS,NSF61,UBA
Curve tolerance: ISO9906:2012 3B

Materials:

Pump housing: Stainless steel
EN 1.4401
AISI 316
Impeller: Stainless steel
EN 1.4401
AISI 316

Installation:

Range of ambient temperature: -20 .. 55 °C
Maximum operating pressure: 10 bar
Max pressure at stated temp: 10 bar / 40 °C
6 bar / 90 °C

Type of connection: Rp
Size of inlet connection: 1 1/4 inch
Size of outlet connection: 1 inch
Outlet position: 12

Electrical data:



Company name:

Created by:

Phone:

Date:

09/05/2023

| Qty. | Description |
|------|-------------|
|------|-------------|

| | |
|---|--------------------------------------|
| 1 | Motor standard: IEC |
| | Frame size: 80B |
| | Rated power - P2: 0.9 kW |
| | Mains frequency: 50 Hz |
| | Suitable for 50/60 Hz: N |
| | Rated voltage: 1 x 220-240 V V |
| | Service factor: 1.00 |
| | Rated current: 5.4-5.0 A |
| | Starting current: 430-430 % |
| | Rated speed: 2750-2790 rpm |
| | Enclosure class (IEC 34-5): IP55 |
| | Insulation class (IEC 85): F |
| | Built-in motor protection: PTO |
| | Cable included (Yes/No): N |
| | Others: |
| | Terminal box position: 12 |
| | Minimum efficiency index, MEI ≥: 0.7 |
| | Net weight: 15.6 kg |
| | Gross weight: 18.1 kg |

96935461 CM 5-5 A-R-G-E-AVBE C-A-A-N 50 Hz

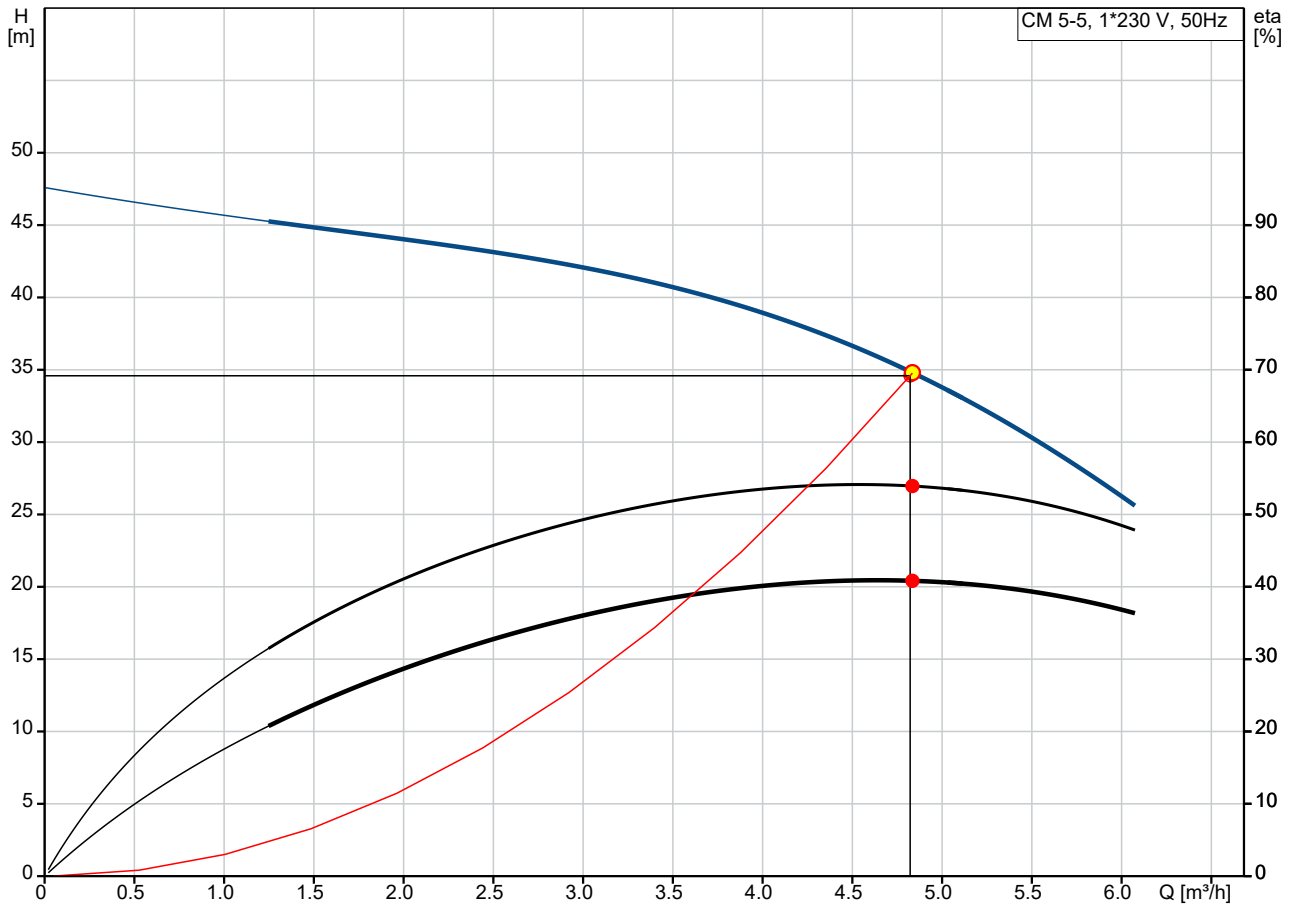

Q = 4.835 m³/h
 n = 2808 rpm
 Liquid temperature during operation = 20 °C
 Eta pump = 53.9 %

H = 34.8 m
 Pumped liquid = Water
 Density = 998.2 kg/m³
 Eta pump+motor = 40.8 %

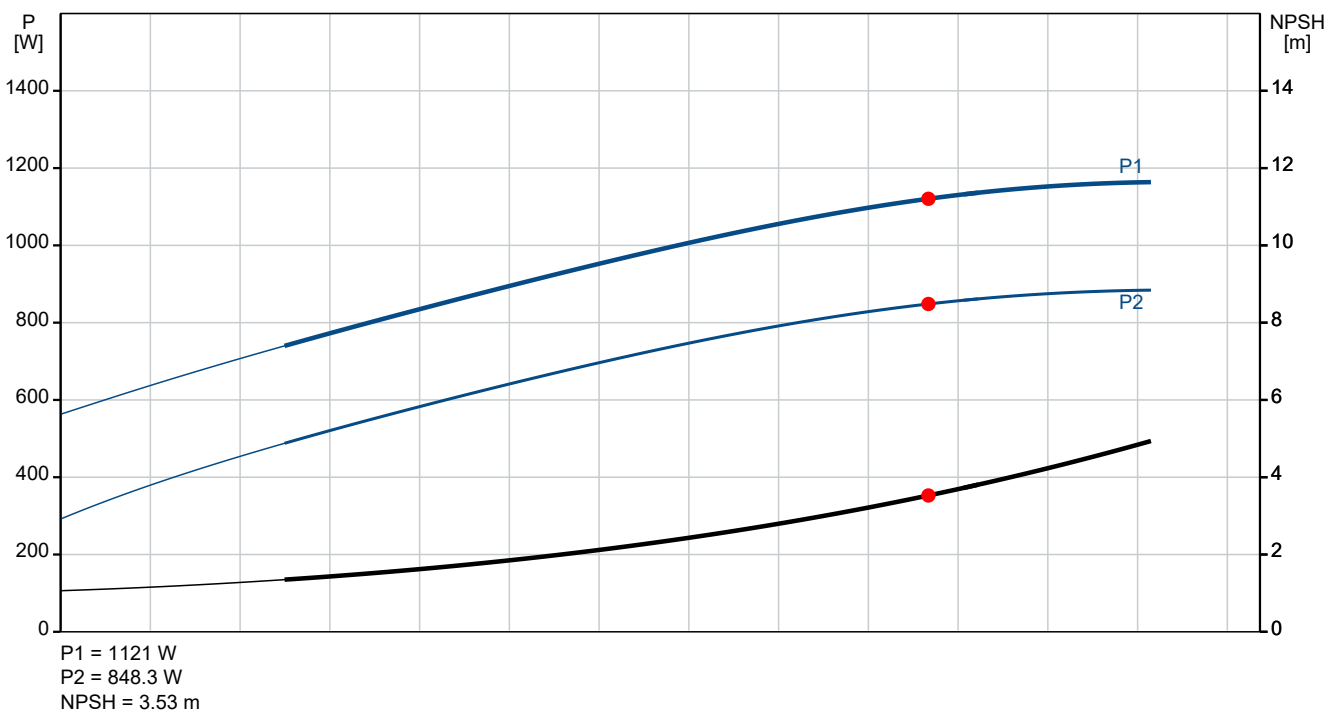

| Description | Value |
|--|-----------------------------|
| General information: | |
| Product name: | CM 5-5 A-R-G-E-AVBE C-A-A-N |
| Product No: | 96935461 |
| EAN number: | 5700314053697 |
| Technical: | |
| Pump speed on which pump data are based: | 2900 rpm |
| Actual calculated flow: | 4.835 m ³ /h |
| Rated flow: | 4.7 m ³ /h |
| Resulting head of the pump: | 34.8 m |
| Rated head: | 38.62 m |
| Impellers: | 5 |
| Code for shaft seal: | AVBE |
| Approvals: | CE,EAC,UKCA |
| Approvals for drinking water: | ACS,NSF61,UBA |
| Curve tolerance: | ISO9906:2012 3B |
| Pump version: | A |
| Model: | A |
| Materials: | |
| Pump housing: | Stainless steel |
| Pump housing: | EN 1.4401 |
| Pump housing: | AISI 316 |
| Impeller: | Stainless steel |
| Impeller: | EN 1.4401 |
| Impeller: | AISI 316 |
| Material code: | G |
| Code for rubber: | E |
| Installation: | |
| Range of ambient temperature: | -20 .. 55 °C |
| Maximum operating pressure: | 10 bar |
| Max pressure at stated temp: | 10 bar / 40 °C |
| Max pressure at stated temp: | 6 bar / 90 °C |
| Type of connection: | Rp |
| Size of inlet connection: | 1 1/4 inch |
| Size of outlet connection: | 1 inch |
| Outlet position: | 12 |
| Connect code: | R |
| Liquid: | |
| Pumped liquid: | Water |
| Liquid temperature range: | -20 .. 90 °C |
| Selected liquid temperature: | 20 °C |
| Density: | 998.2 kg/m ³ |
| Electrical data: | |
| Motor standard: | IEC |
| Frame size: | 80B |
| Rated power - P2: | 0.9 kW |
| Mains frequency: | 50 Hz |
| Suitable for 50/60 Hz: | N |
| Rated voltage: | 1 x 220-240 V V |
| Service factor: | 1.00 |
| Rated current: | 5.4-5.0 A |
| Starting current: | 430-430 % |
| Rated speed: | 2750-2790 rpm |
| Enclosure class (IEC 34-5): | IP55 |
| Insulation class (IEC 85): | F |
| Built-in motor protection: | PTO |
| Cable included (Yes/No): | N |
| Controls: | |

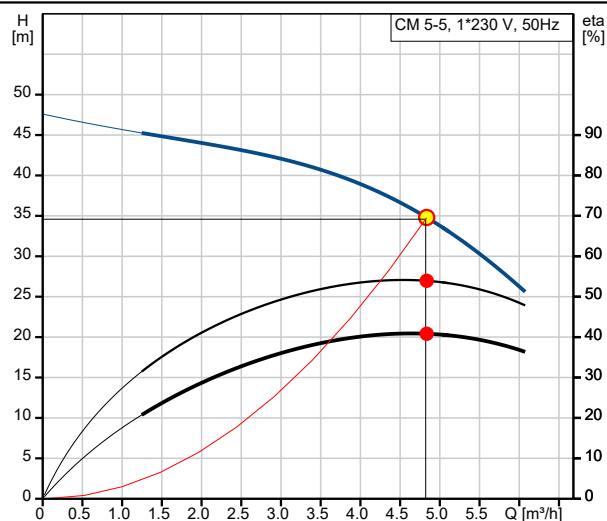

Q = 4.835 m³/h
 n = 2808 rpm
 Density = 998.2 kg/m³
 Eta pump+motor = 40.8 %
 Liquid temperature during operation = 20 °C

H = 34.8 m
 Pumped liquid = Water
 Eta pump = 53.9 %

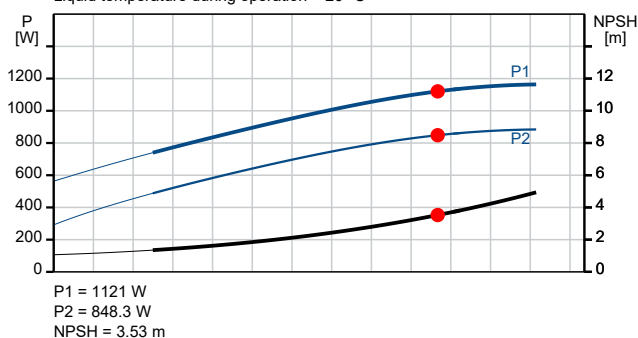



Company name:

Created by:

Phone:

Date:

09/05/2023

| Description | Value |
|----------------------------------|---------|
| Frequency converter: | NONE |
| Others: | |
| Terminal box position: | 12 |
| Minimum efficiency index, MEI ≥: | 0.7 |
| Net weight: | 15.6 kg |
| Gross weight: | 18.1 kg |

96935461 CM 5-5 A-R-G-E-AVBE C-A-A-N 50 Hz

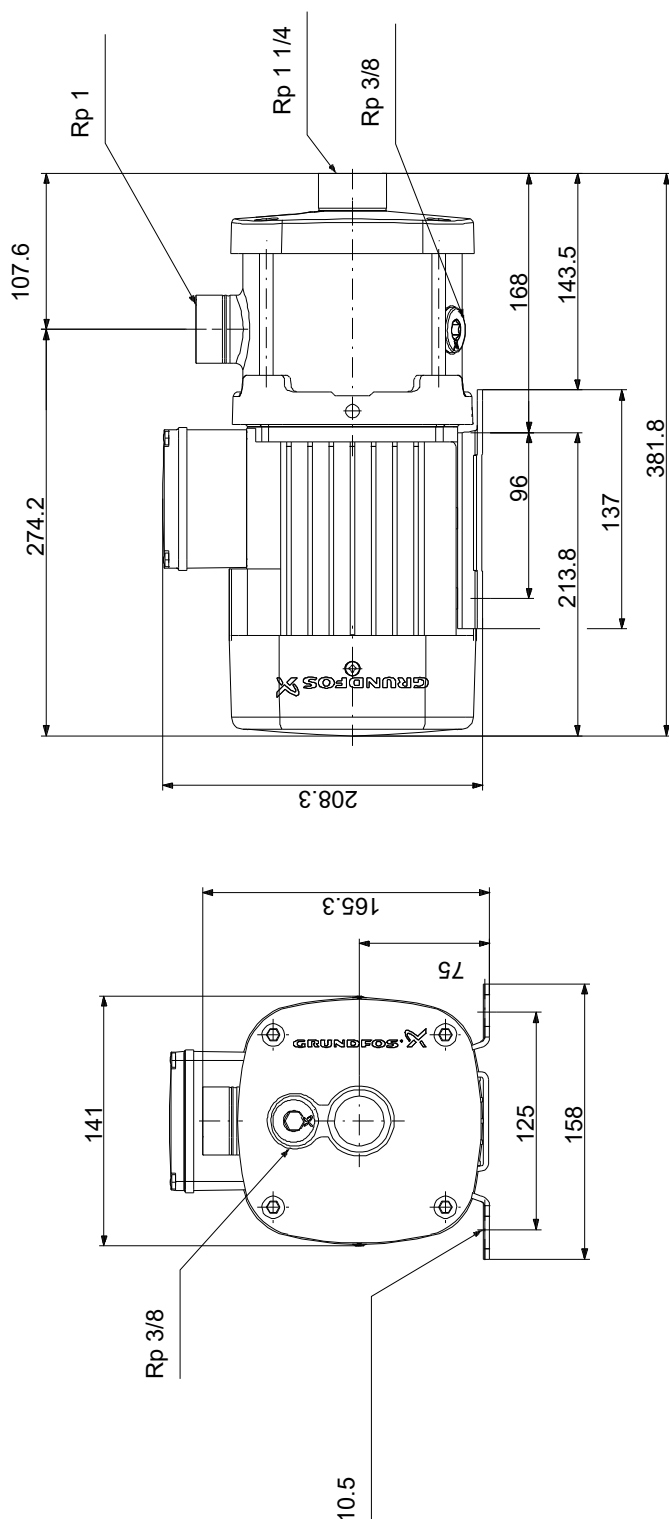

Note! All units are in [mm] unless others are stated.
Disclaimer: This simplified dimensional drawing does not show all details.